

Prolonged unprotected exposure to heat may be detrimental to the appearance or long term performance of a wall finish. Combustible and heat sensitive wall panels or finishes must not protrude past the trim, to the glass viewing area. Some scenarios will require a custom solution, to provide further protection.

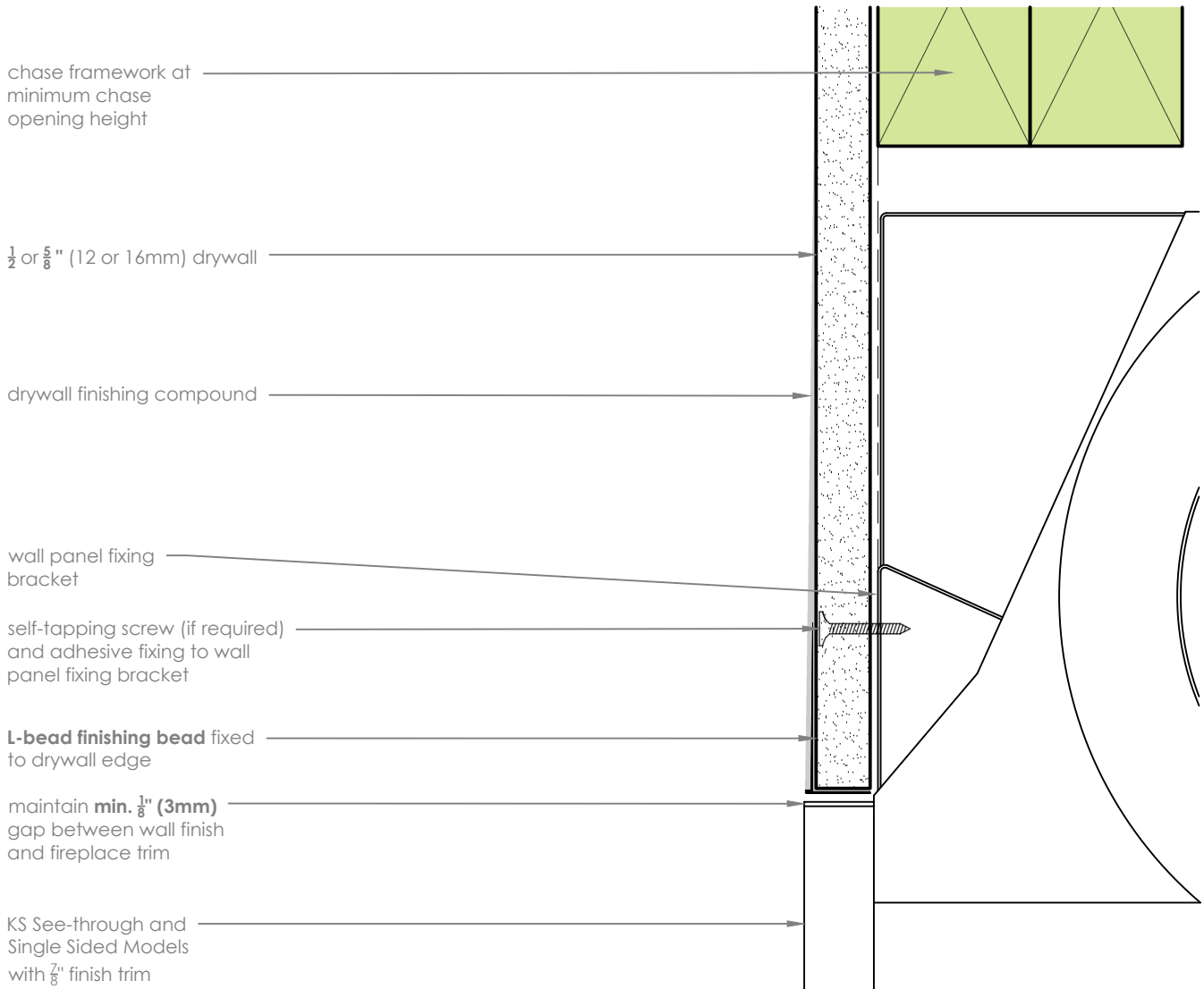

Drywall L- Bead Finish

scale 1:2

Applicable for:

KS55 Mesh Barrier Single Sided
 KS55 Mesh Barrier See-Through
 KS55 Glass Barrier Single Sided
 KS55 Glass Barrier See-Through
 KS75 Glass Barrier Single Sided
 KS75 Glass Barrier See-Through

Notes:

- DO NOT SCALE OFF THESE DRAWINGS
- This detail is to assist in the installation of a **frameless finish** to a KS Series Gas Fireplace.
- This detail is suitable for all four sides of the fireplace glass viewing area.
- **Do not excessively push back wall board when fixing it to the fire chassis** - use large daubs of adhesive to the appliance chassis, apply wall lining and flush finish with edge of the fireplace trim.
- Follow the manufacturer's instructions for specifying and installing wall panels or finishes. Escea takes no responsibility for material selection.
- The Specifier and/or Installer are responsible for compliance with all relevant Building Codes.
- This technical sheet must be read in conjunction with the requisite Escea KS Series Installation Manual, the latest version can be found on our website at www.escea.com.

GENERAL CONSTRUCTION AND FINISHES SHOWN INDICATIVE ONLY

Contact the ESCEA Architectural Advisory Team for assistance with the specification of this fire - aa@escea.com

Prolonged unprotected exposure to heat may be detrimental to the appearance or long term performance of a wall finish. Combustible and heat sensitive wall panels or finishes must not protrude past the trim, to the glass viewing area. Some scenarios will require a custom solution, to provide further protection.

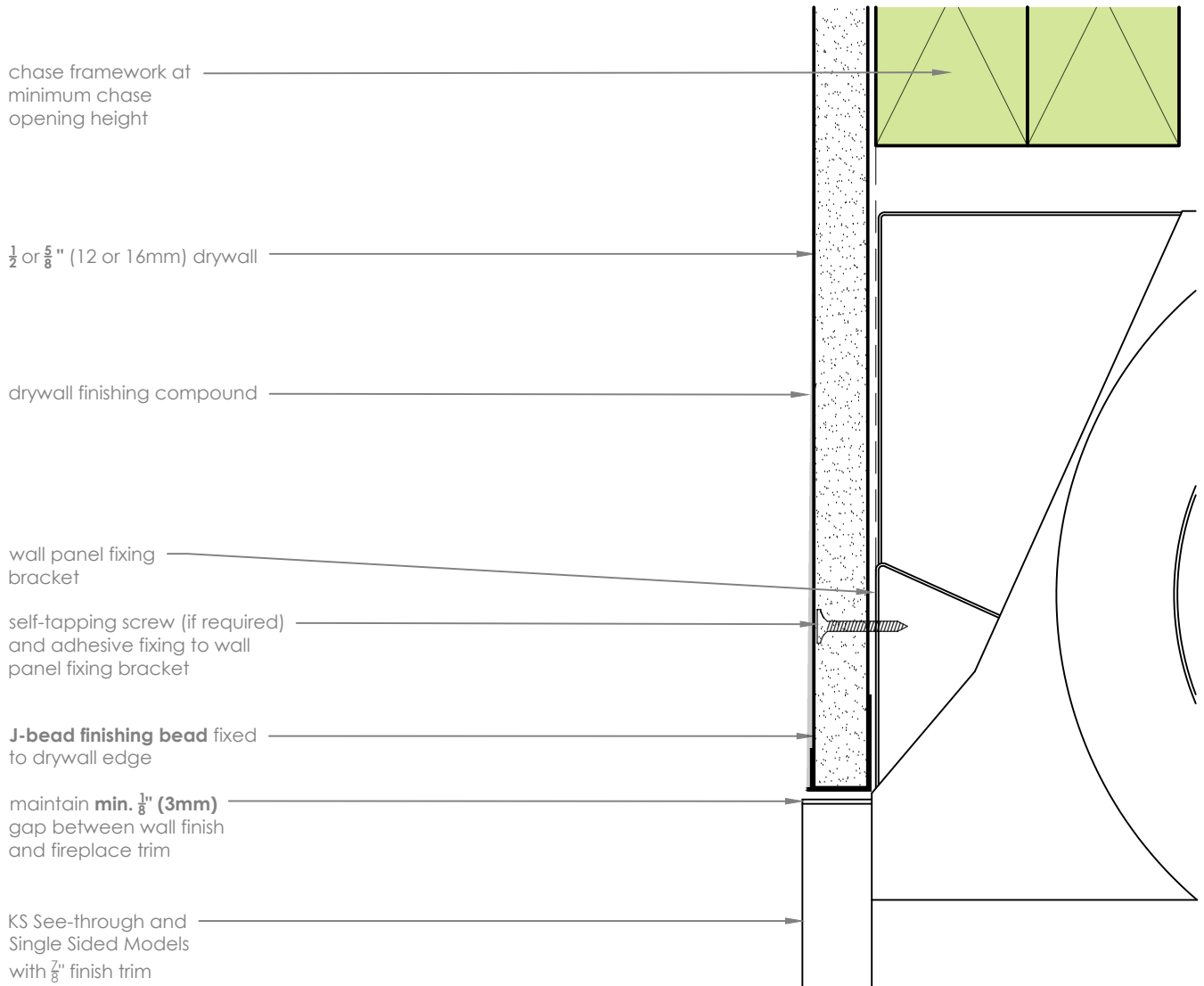

Drywall J-Bead Finish

scale 1:2

Applicable for:

KS55 Mesh Barrier Single Sided
 KS55 Mesh Barrier See-Through
 KS55 Glass Barrier Single Sided
 KS55 Glass Barrier See-Through
 KS75 Glass Barrier Single Sided
 KS75 Glass Barrier See-Through

Notes:

- DO NOT SCALE OFF THESE DRAWINGS
- This detail is to assist in the installation of a **frameless finish** to a KS Series Gas Fireplace.
- This detail is suitable for all four sides of the fireplace glass viewing area.
- **Do not excessively push back wall board when fixing it to the fire chassis** - use large daubs of adhesive to the appliance chassis, apply wall lining and flush finish with edge of the fireplace trim.
- Follow the manufacturer's instructions for specifying and installing wall panels or finishes. Escea takes no responsibility for material selection.
- The Specifier and/or Installer are responsible for compliance with all relevant Building Codes.
- This technical sheet must be read in conjunction with the requisite Escea KS Series Installation Manual, the latest version can be found on our website at www.escea.com.

GENERAL CONSTRUCTION AND FINISHES SHOWN INDICATIVE ONLY

Contact the ESCEA Architectural Advisory Team for assistance with the specification of this fire - aa@escea.com